

MULTIPOINT LOCKING FLUVERI



Automatic closing, reliable locking

Enhanced anti-burglary protection

The Gilgen multipoint locking FLUVERI, a highquality lock system, guarantees a fast and safe locking and unlocking of the door. It is invisibly incorporated into the vertical profile of the door leaves. Thanks to the pivoting locking bolts, the door is efficiently protected against forced opening attempts using lever action from any direction. As an option, this system can be complemented by a door and lock-monitoring feature.

Automatic door leaf locking

The locking and unlocking is automatically achieved in a matter of seconds via the locking motor integrated in the door leaf. By means of a freewheel cylinder, the locking mechanism can be manually operated by means of a key, from inside and/or outside at a convenient service height. The locked door can also be unlocked and opened from inside using the manual unlocking lever available as an option.

Manual door leaf locking

The door can be locked and unlocked from inside and/or from the outside at a convenient service height by means of a key. For installations equipped with fix-point door leaf guide shoes, an additional bolt for securing the door leaf towards the bottom is available; this option, however, causes a slight reduction of the door's clear width.



The two-way interlocking prevents the door leaves from being easily forced open.

Application with Gilgen profile systems PSX, PSXP, PSW

	automatic locking	manual locking
SLX	•	•
SLX redundant	•	•
SLX-M	•	•
SLX-M redundant	•	•
SLX Break Out	•	•
SLA		•

- Manual locking
- Additional components for automatic locking
- Options:
 - Locking bolt engaging into the floor (only with manual version)
 - Manual unlocking device
 - Lock monitoring feature

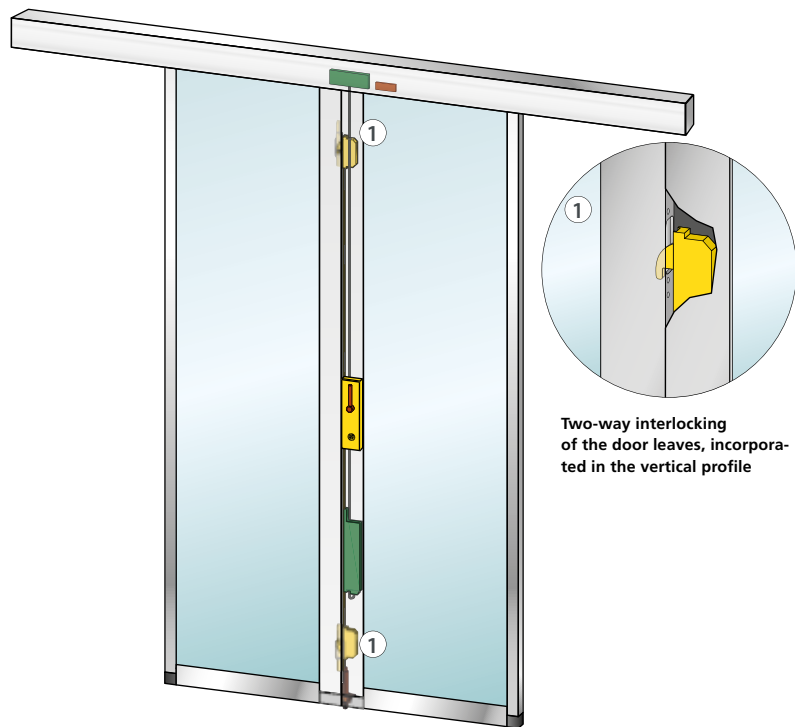

Two-way interlocking of the door leaves, incorporated in the vertical profile



Manual locking / unlocking via key or rotarytype knob from inside and/or outside

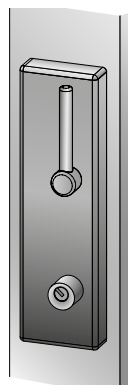

Option: Manual unlocking device Standard, inside



Option: Manual unlocking device for SLX Break-Out, inside

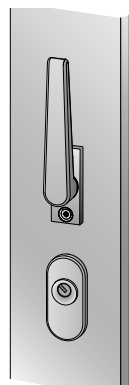

Option: Manual unlocking device for PSW <green wings> (completely integrated in the profile), inside

Locking appropriate for:



Round cylinder

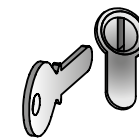

Profile cylinder